

Hydraulic Adapters - NPTF

Male Pipe Tees

Specifications

- Reference SAE 140437
- Pressure rating at 70°F (21°C)



Male NPTF (3)	PSI	Zinc Plated Steel Part #
1/4"-18	5000	5600-4
3/8"-18	4000	5600-6
1/2"-14	3000	5600-8
3/4"-14	2500	5600-12
1"-11-1/2	2000	5600-16

Male x Female Pipe Tees

Specifications

- Reference SAE 140427
- Pressure rating at 70°F (21°C)

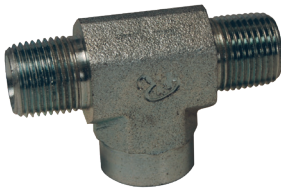

Male NPTF (2)	Female NPTF	PSI	Zinc Plated Steel Part #
1/4"-18	1/4"-18	5000	5601-4
3/8"-18	3/8"-18	4000	5601-6
1/2"-14	1/2"-14	3000	5601-8
3/4"-14	3/4"-14	2500	5601-12
1"-11-1/2	1"-11-1/2	2000	5601-16

Female x Male Branch Tees

Specifications

- Reference SAE 140425
- Pressure rating at 70°F (21°C)



Female NPTF (2)	Male NPTF	PSI	Zinc Plated Steel Part #
1/4"-18	1/4"-18	5000	5604-4
3/8"-18	3/8"-18	4000	5604-6
1/2"-14	1/2"-14	3000	5604-8
3/4"-14	3/4"-14	2500	5604-12
1"-11-1/2	1"-11-1/2	2000	5604-16

Female Pipe Tees

Specifications

- Reference 140438
- Pressure rating at 70°F (21°C)

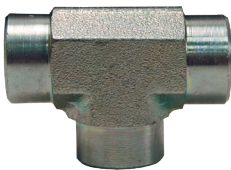

Female NPTF (3)	PSI	Zinc Plated Steel Part #
1/4"-18	5000	5605-4
3/8"-18	4000	5605-6
1/2"-14	3000	5605-8
3/4"-14	2500	5605-12
1"-11-1/2	2000	5605-16

Male x Female Run Tees

Specifications

- Reference 140424
- Pressure rating at 70°F (21°C)

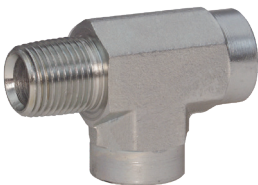

Male NPTF	Female NPTF (2)	PSI	Zinc Plated Steel Part #
1/8"-27	1/8"-27	5000	5602-2
1/4"-18	1/4"-18	5000	5602-4
3/8"-18	3/8"-18	4000	5602-6
1/2"-14	1/2"-14	3000	5602-8
3/4"-14	3/4"-14	2500	5602-12
1"-11-1/2	1"-11-1/2	2000	5602-16
1-1/4"-11-1/2	1-1/4"-11-1/2	1150	5602-20
1-1/2"-11-1/2	1-1/2"-11-1/2	1000	5602-24

K