

ULC UL Reversible Concealed Angle Siamese Body

23-393

Application:

The unique design of clappers is fully reversible with a perpendicular trunnion allowing one body to be installed for top and bottom connections.

Features:

- U/L listed
- approved by New York City Board of Standards and Appeals
- for use up to **250 PSI** at 70°F (21°C)



Outlet Female NPT	(2) Inlets Female NPT	Brass Part #	Powhatan Part #	Wt. Lbs.
4"	2½"	4025REV90	23-393-00001	19
4"	3"	4030REV90	23-393-00002	19

Dimensions

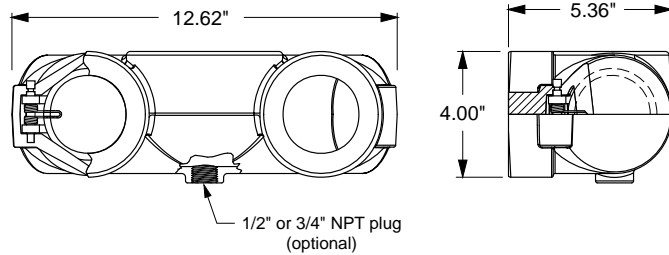

Reversible Concealed Angle Siamese Body

(7-5/8" Centers)

Application:

The unique design of clappers is fully reversible with a perpendicular trunnion allowing one body to be installed for top and bottom connections.

Features:

- replaced 23-391 bodies
- for use up to **250 PSI** at 70°F (21°C)



Outlet Female NPT	(2) Inlets Female NPT	Brass Part #	Wt. Lbs.
5"	2½"	90CREV5025	30
5"	3"	90CREV5030	28
6"	2½"	90CREV6025	27
6"	3"	90CREV6030	25

Dimensions

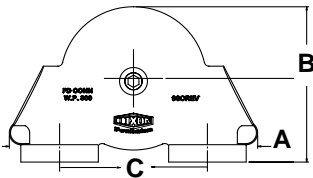

Size	A	B	C
5 x 3 x 3	12"	9-1/2"	7-5/8"
6 x 2½ x 2½	12"	7-1/4"	7-5/8"
6 x 3 x 3	12"	9-1/2"	7-5/8"

Bodies require wall plate WP2
see page 744

O