

Boss Male Stems

Feature

- Use with Boss clamps on pages 159 - 160 for safety tags and safety tape see page 1062

Specification

- Recommended for steam service up to 450°F (232°C)

Hose x NPT size	Plated Steel Bar Stock Part #	Opt Qty	Size	Plated Iron Part #	Opt Qty
1/4" x 1/8"	MS4X2	100	---	---	---
1/4" x 1/4"	MSA	100	---	---	---
1/4" x 3/8"	MSB	25	---	---	---
3/8" x 1/4"	MS6X4	100	1-1/4"	MS16	20
3/8" x 3/8"	MSC	100	1-1/2"	MS21	20
3/8" x 1/2"	MS6X8	50	2"	MS26	10
1/2" x 1/4"	MS8X4	50	2-1/2"	MS31	5
1/2" x 3/8"	MS8X6	50	3"	MS36	5
1/2" x 1/2"	MS1	50	4"	MS46	2
1/2" x 3/4"	MS8X12	25	---	---	---
3/4" x 1/2"	MS12X8	25	---	---	---
3/4" x 3/4"	MS6	50	---	---	---
3/4" x 1"	MS12X16	25	---	---	---
1" x 3/4"	MS16X12	25	---	---	---
1" x 1"	MS11	25	---	---	---

Size	316 Stainless Part #	Size	Brass Part #
1/2"	RMS1	---	---
3/4"	RMS6	3/4"	BMS6
1"	RMS11	1"	BMS11
1-1/4"	RMS16	1-1/4"	BMS16
1-1/2"	RMS21	1-1/2"	BMS21
2"	RMS26	2"	BMS26
2-1/2"	RMS31	---	---
3"	---	3"	---



plated steel



plated iron

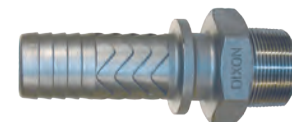

316 stainless



brass