



Customer Service
877.963.4966



Materials

- Casing: 316L stainless steel
- Impeller: CF8M (316) stainless steel
- Back plate: 316L stainless steel
- Stub shaft: 316L stainless steel
- Adapter: 304 stainless steel
- Seal types: externally balanced 'D', 'DG' and 'F' with clamped in seat
- Rotary seat material: carbon and silicon carbide
- DG seal seat material: silicon carbide, ceramic, and tungsten carbide
- Elastomers: nitrile rubber, EPDM, silicone, and FKM
- Finish: sanitary polish 32 Ra

Specifications

- Nominal capacity: up to **1200 GPM**
- Temperature range: **32°F (0°C) to 212°F (100°C)**
- Nominal speed: 3500 RPM (60 Hz)
- F-seal - cascade flush option for D or DG seal
- 100% CIP-able

Options

- Motor: standard C-Face, 1750 and 3450 RPM, TENV/TEFC and washdown, foot mounted
- Additional motor types available upon request
- Mounting: pump head mounted to a C-Face motor
- Optional leg kit: 304 stainless steel

Features

- Casing is stamped, not cast, for lighter weight and less porosity
- Hydraulically, dimensionally and parts interchangeability with other C-series pumps
- Adapter/guard set updated for easier maintenance, enhanced work area, effortless guard removal, and installation
- Safer cage-less guard design
- BC-series features impeller retainer
- BP-series features threaded impeller nut
- Pumps can be sold as a wet end only, complete motor pump unit and mounted on a cart

NOTE: Stock on all sizes and complete units can ship in 2-5 days ARO

Pump Curves

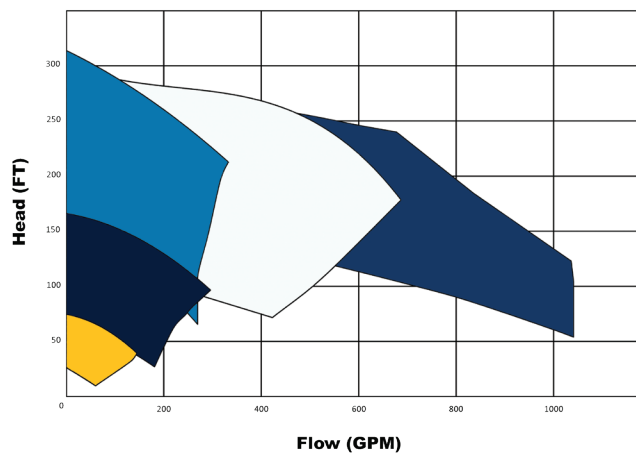
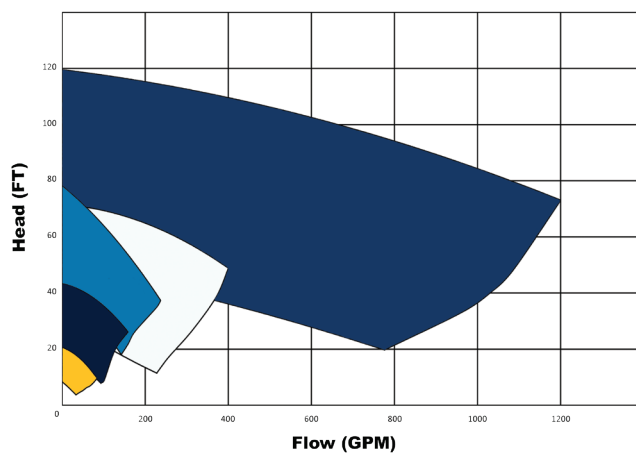



BC/BP-Series Centrifugal Pump

Series	Port Size	Connections	Impeller Size
BC114	1-1/2" or 2"	1-1/2"	4"
BC216	2" or 2-1/2"	1-1/2"	6"
BC218	2" or 3"	1-1/2"	8"
BC328	3" or 4"	2"	8"
BP441*	4" or 6"	4"	10"

* BP threaded nut and DG seal only

BC/BP-Series Centrifugal Pump

A[®]
3
1537
02-12

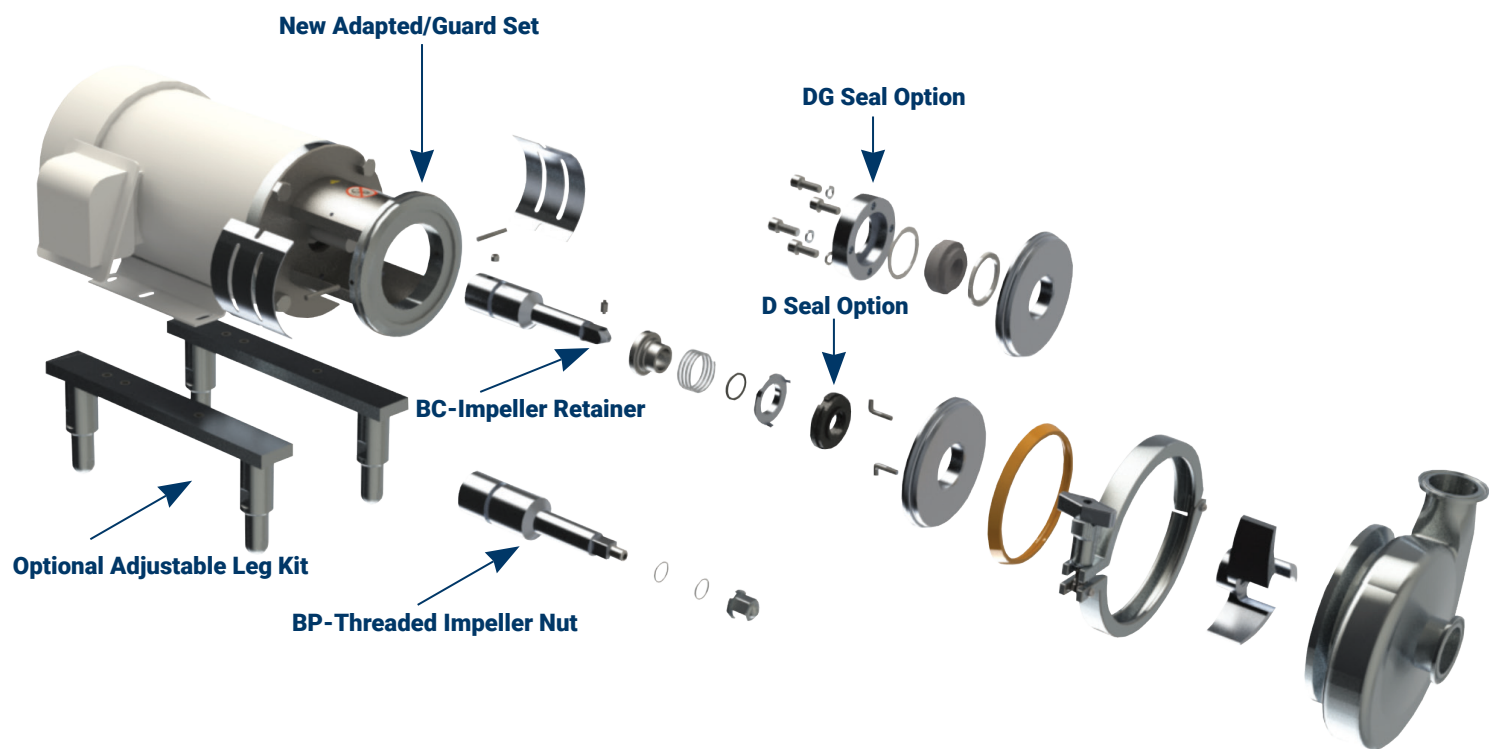



**2200 Logan Avenue
Winnipeg, MB R2R 0J2
Phone: 877.963.4966
Fax: 204.633.6119**

connect with us on



Dixon®, founded in 1916, is a premier manufacturer and supplier of hose couplings, valves, dry-disconnects, swivels, and other fluid transfer and control products. The company's global reach includes a wide range of products for numerous industries including petroleum exploration, refining, transportation, chemical processing, food and beverage, steel, fire protection, construction, mining, and manufacturing. Dixon's strategic objective is to create solutions that make products safer, leak-free, longer-lasting, and always available.