

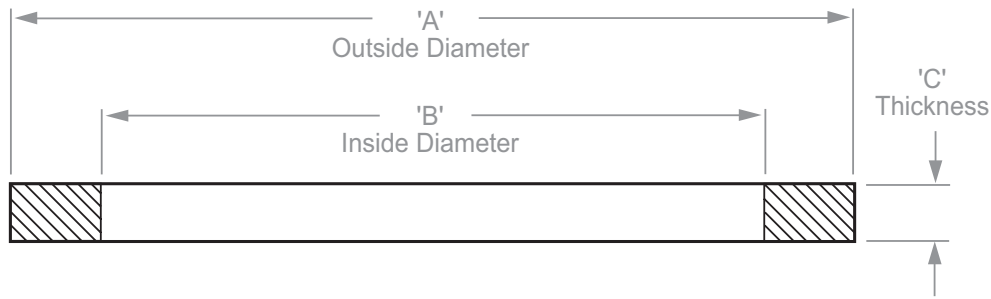

## Cam &amp; Groove Gasket Dimensions



- nominal dimensions for elastomeric cam & groove gaskets are listed
- ID's of the PTFE envelope gaskets and the PTFE accordion gaskets are *1/16" smaller than* the ID's for the elastomeric gaskets shown below
- thickness of PTFE accordion gaskets may vary from chart below

Size	Part #	Dimensions		
		A	B	C
1/2"	<b>50-G</b> <sup>1</sup>	1-1/32"	11/16"	.156"
3/4"	<b>75-G</b>	1-3/8"	7/8"	.218"
1"	<b>100-G</b>	1-9/16"	1-1/16"	.250"
1 1/4"	<b>125-G</b>	1-15/16"	1-23/64"	.250"
1 1/2"	<b>150-G</b>	2-3/16"	1-5/8"	.250"
2"	<b>200-G</b>	2-5/8"	2"	.250"
2 1/2"	<b>250-G</b>	3-1/8"	2-3/8"	.250"
3"	<b>300-G</b>	3-23/32"	3"	.250"
4"	<b>400-G</b>	4-7/8"	4"	.250"
5"	<b>500-G</b>	5-15/16"	4-7/8"	.250"
6"	<b>600-G</b>	7-1/16"	6"	.250"
8"	<b>800-G</b> <sup>1</sup>	9-5/16"	8-1/8"	.343"

<sup>1</sup> No interchange standard exists for the 1/2" and 8" fittings. Generally, these sizes do not interchange with other manufacturer's products. As such, the gaskets in these sizes are not suitable for use in other manufacturers' couplings. 

## Cam &amp; Groove Gasket Color Codes

Gasket Code <sup>1</sup>	Material	Color	Color code stripes (appear on the OD of the gasket or filler)
<b>-BU</b>	<i>Buna-N</i> (standard in all metal fittings)	black	1 blue
<b>-BF</b>	<i>Buna</i> (formulated for fuel service)	black	1 green
<b>-VI</b>	<i>FKM</i>	black	1 yellow
<b>-THK</b>	<i>Extra Thick Buna</i>	black	2 blue
<b>-EPR</b>	<i>Ethylene Propylene</i>	black	1 white
<b>-NE</b>	<i>Neoprene</i>	black	1 red
<b>-WNE</b>	<i>White Neoprene</i> , FDA approved material	white	none
<b>-WB</b>	<i>White Buna-N</i> , FDA approved material	white	blue
<b>-SIL</b>	<i>Silicone</i>	red	none
<b>-TF</b>	<i>PTFE (TFE) envelope with Buna-N filler</i>	white / black	1 blue
<b>TFVI</b>	<i>PTFE (TFE) envelope with FKM filler</i>	white / black	1 yellow
<b>TFWB</b>	<i>PTFE (TFE) envelope with White Buna-N filler</i> , FDA approved materials	white / white	blue
<b>TFEP</b>	<i>PTFE (TFE) envelope with Ethylene Propylene filler</i>	white / black	1 white stripe
<b>-TES</b>	<i>PTFE (FEP) encapsulated Silicone core</i> , FDA approved materials	translucent / red	none
<b>-TEV</b>	<i>PTFE (FEP) encapsulated FKM core</i>	translucent / black	none
<b>TFACC</b>	<i>PTFE (TFE) accordion</i> , FDA approved materials	white	none

<sup>1</sup> part number suffix

Since other manufacturer's coding systems vary, this chart should not be used as a reference in identifying gaskets of unknown origin. 