

Single Clapper Siamese Connections

Application:

Single swing clapper with (2) pin lug swivel inlets. Provides the required 500 GPM minimum to supplement the fire protection as an auxiliary inlet connection to the water supply. (250 GPM minimum per inlet.) The swing clapper design provides unobstructed waterway. Exposed Fire Department Connections (FDC) provide an economical method of satisfying local fire codes.

Features:

- branding: Auto-Sprk
- finish: -P polished or -C polished chrome plated
- for use up to **250 PSI** at 70°F (21°C)

back outlet
21-201



- U/L listed and FM approved

| (2) Inlets Female | Outlet Female NPT | Cast Brass Part # | Wt. Lbs. |
|-------------------|-------------------|----------------------------|----------|
| 2½" CT | 4" | SCS4025 ¹ | 19.0 |
| 2½" NH (NST) | 4" | ISCS4025F | 7.5 |
| --- | 4" | ISCS4025-BODY ² | 7.0 |

¹ Customer Thread (*must specify*) refer to legend on page 705

² swivels can be ordered on page 846 for a quick special thread FDC

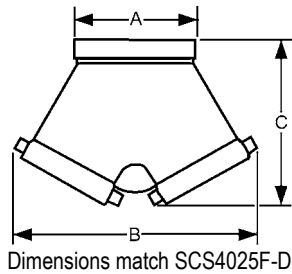

Dimensions

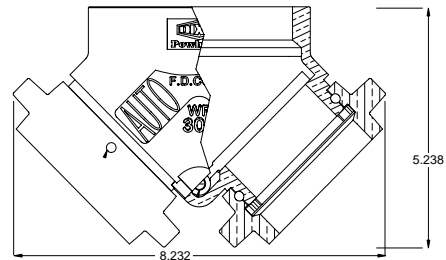

| Size | A | B | C |
|-------------|--------|----|---------|
| 4 x 2½ x 2½ | 5-1/8" | 9" | 6-1/16" |

bottom outlet

21-202



- U/L listed

| (2) Inlets Female | Outlet Female NPT | Cast Brass Part # | Wt. Lbs. |
|-------------------|-------------------|------------------------------|----------|
| 2½" NH (NST) | 4" | 90SCS4025F-SP | 19.0 |
| 2½" CT | 4" | 90SCS4025 ¹ | 7.5 |
| 2½" NH (NST) | 4" | 90ISCS4025F | 7.0 |
| --- | 4" | 90ISCS4025-BODY ² | |

¹ Customer Thread (*must specify*) refer to legend on page 705

² swivels can be ordered on page 846 for a quick special thread FDC

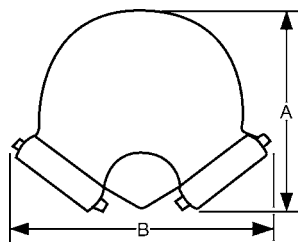

Dimensions

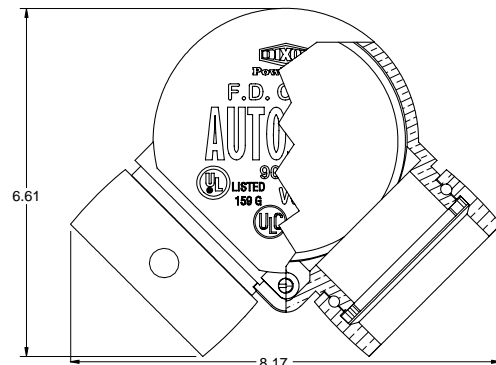

| Size | A | B |
|-------------|--------|--------|
| 4 x 2½ x 2½ | 6-7/8" | 9-7/8" |