

# UL Two Way Male Outlet - Roof Connections

26-294 / 26-296

**Application:**

Used to create roof connections, fire pump test connections, wall hydrants or sidewalk (free standing) hydrants. Provides 250 GPM minimum per outlet.

**Features:**

- U/L listed
- for use up to **175 PSI** at 70°F (21°C)

## back inlet

26-294



Pipe Size	(2) Outlets Male	Cast Brass Part #	Powhatan Part #	Wt. Lbs.
4"	2½" NPT	<b>IRC4025</b>	---	9.50
	2½" NPT	<b>FRC4025-D</b>	26-294-00001	9.50
	2½" NH (NST)	<b>IRC4025F</b>	---	9.50
	2½" NH (NST)	<b>FRC4025F-D</b>	26-294-00003	9.50
	2½" CT	<b>FRC4025</b> <sup>1</sup>	---	9.50
6"	2½" NPT	<b>FRC6025</b>	26-294-00010	14.25
	2½" NH (NST)	<b>FRC6025F</b>	26-294-00011	14.25
	2½" CT	<b>FRC6025</b> <sup>1</sup>	---	14.25

<sup>1</sup> Customer Thread (*must specify*) refer to legend on page 705

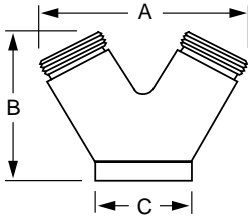

Groove Size	(2) Outlets Male	Cast Brass Part #	Wt. Lbs.
4"	2½" MNPT	<b>IRC4025G</b>	7.05
4"	2½" MNST	<b>IRC4025GF</b>	7.05

### Dimensions

Size	A	B	C
4 x 2½ x 2½	7-7/8"	5-3/16"	5-1/4"
6 x 2½ x 2½	8-3/16"	6-3/8"	7-5/8"

## 90° bottom inlet

26-296



Pipe Size	(2) Outlets Male	Cast Brass Part #	Powhatan Part #	Wt. Lbs.
4"	2½" NPT	<b>90IRC4025</b>	---	6.00
	2½" NPT	<b>90FRC4025-D</b>	26-296-00002	8.25
	2½" NH (NST)	<b>90IRC4025F</b>	---	6.00
	2½" NH (NST)	<b>90FRC4025F-D</b>	26-296-00003	8.25
	2½" CT	<b>90FRC4025</b> <sup>1</sup>	---	8.25
6"	2½" NPT	<b>90FRC6025</b>	26-296-00008	15.80
	2½" NH (NST)	<b>90FRC6025F</b>	26-296-00011	15.80
	2½" CT	<b>90FRC6025</b> <sup>1</sup>	---	15.80

<sup>1</sup> Customer Thread (*must specify*) refer to legend on page 705

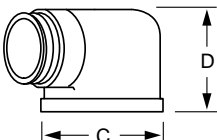
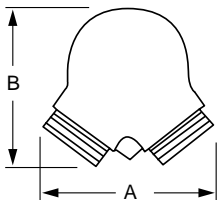

Groove Size	(2) Outlets Male	Cast Brass Part #	Wt. Lbs.
4"	2½" MNPT	<b>90IRC4025G</b>	7.05
4"	2½" MNST	<b>90IRC4025GF</b>	7.05

### Dimensions

Size	A	B	C	D
4 x 2½ x 2½	7-1/2"	6-3/4"	5-1/8"	4-1/2"
6 x 2½ x 2½	9"	8-1/2"	7-1/2"	5"